

GFC 202 / 203 AND 204 ASSEMBLY INSTRUCTIONS

PART LIST

Part No	Component	Quantity
01	Back	01
02	RH SIDE with locking rod	01
03	LH SIDE	01
04	TOP	01
05	BOTTOM TRAY	01
06	Bottom Front	01
07	CENTRE TIE	1,2 & 2
08	CORNER PIECES	01
09	LOCK	01
10	RIVETS 3.2X8- For Drawer	22,34 & 44
11	RIVETS 4X8- For Carcass	32,34 & 36
12	RIVETS 3.2X16 FOR	4,6 & 8
13	SLIDES (PAIRS)	2,3 & 4
14	DRAWER BODY	2,3 & 4
15	DRAWER FRONT	2,3 & 4
16	DRAWER BACK	2,3 & 4
17	DRAWER INSIDE COVER	2,3 & 4
18	ANTI TILT BRACKETS	2,3 & 4
19	PLASTIC RAILINGS	4,6 & 8

*** THE QUANTITY OF ITEMS IS GIVEN FOR GFC2, 3 AND 4 RESPECTIVELY ***

STEP-1

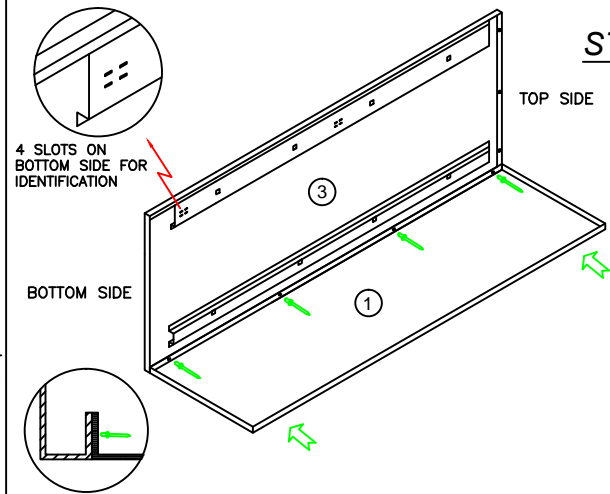

1. Place the back Panel on the Flat surface(Assly Table).
2. Position the LH side with back panel as shown on the enlarged view and rivet with the back panel as shown.

STEP-2

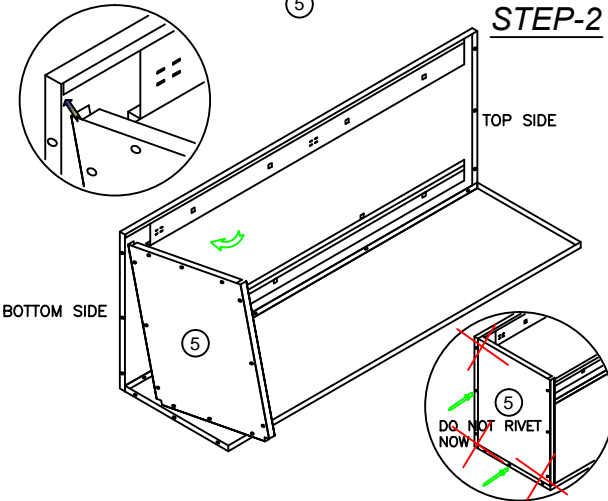

1. Insert the Bottom tray into the side front fold as shown and position inside the bottom tray and the side fold as shown.
2. Rivet only the centre rivet with the side and the bottom tray for holding DO NOT RIVET OTHERS.

STEP-3

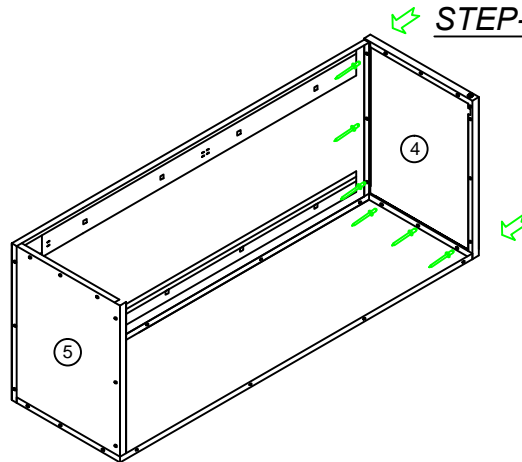

1. Position the top with the side and back as shown and rivet with side and back.

STEP-4

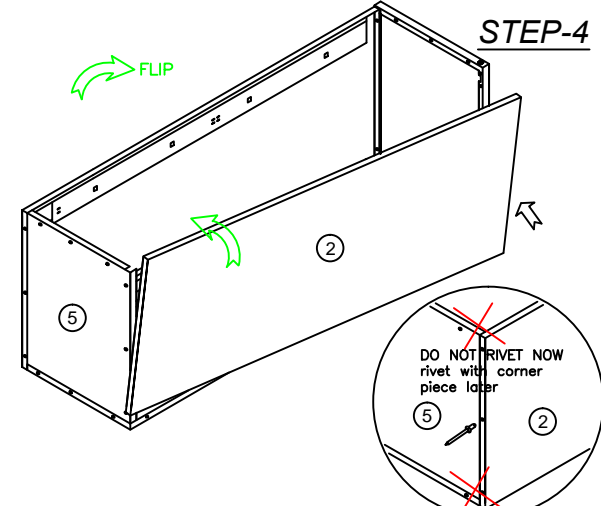

1. Fix the RH Side (with locking rod) as shown and rivet the centre hole of the bottom side flange with bottom tray as shown.
1. Flip around the carcass on its RH side for easy rivetting of side with top and back.

STEP-5

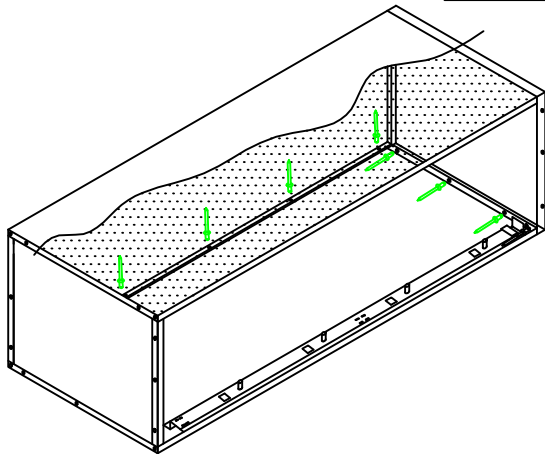

1. Rivet the RH side with the back and top from inside as shown.

STEP-6

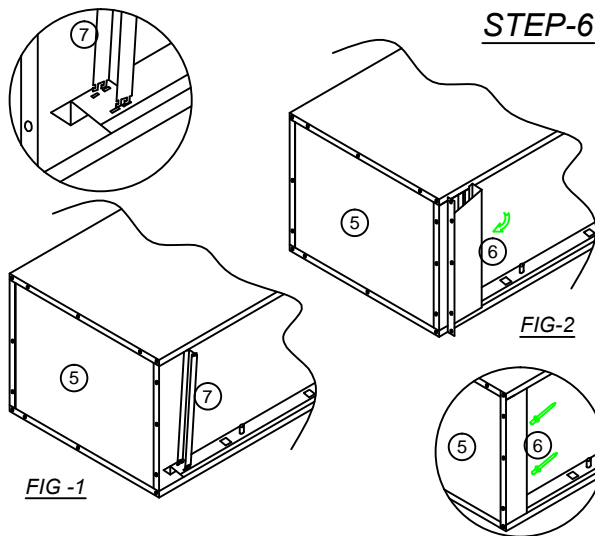

1. Fix bottom Centre tie as shown in FIG-1.
2. Fix the bottom front as shown in FIG-2 and rivet with the centre tie as shown.

STEP-7

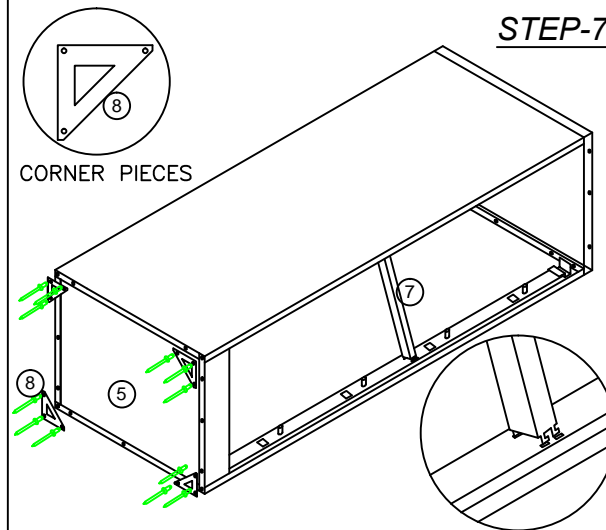

1. Rivet the 4 corner pieces as shown on the bottom tray (Use a 4 mm rod for aligning holes if necessary).
2. Fix the Centre Tie as shown and then lift erect the cabinet for drawers fixing

STEP-8

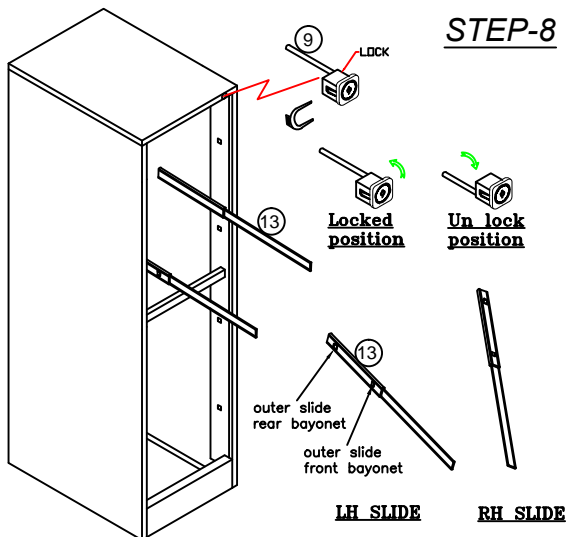

1. Fix the slides as shown.
2. Position the lock into the lock slot in UNLOCK position and then fix the C-Clip from behind the top as shown.

STEP-9

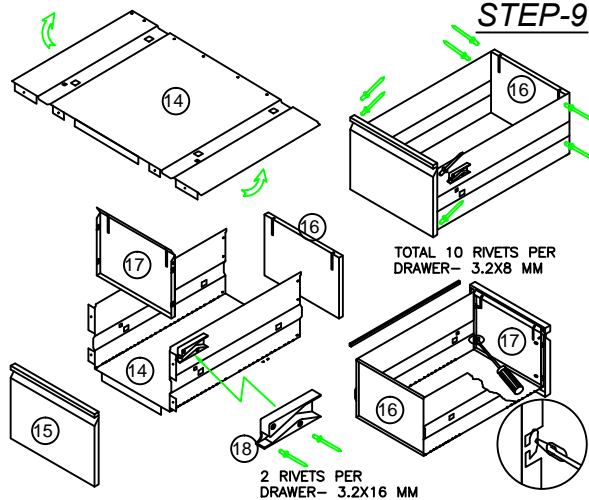

1. Fold the drawer body and rivet the drawer back, drawer front and anti tilt bracket as shown.
2. Fix the drawer inside cover and lock the inside cover tabs using the screw driver as shown and fix the railings on the drawer edges.

STEP-10

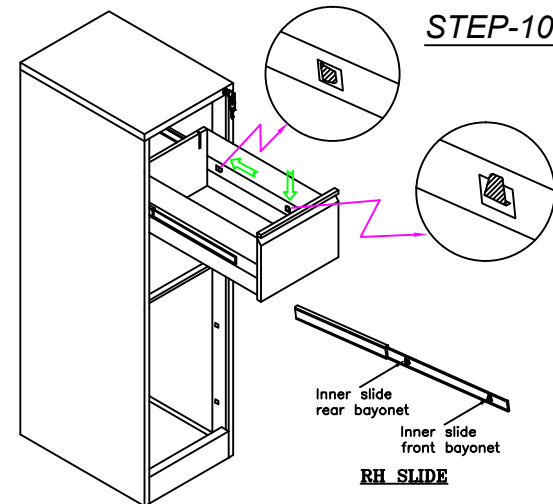

1. Pull the inner slide members outwards and position the rear bayonet on the drawer body and press the drawer downward as shown.
2. Similarly fix all the drawers and now the cabinet is ready to use.